



Mrs. Mr.

Vence,

## CORSAIRE N°

# RESERVATION VOUCHER FOR MOBILE HOME

Please return completed, signed, form to us with your deposit

I would like to reserve a **mobile home CORSAIRE**,

**FROM**.....5 - 7 p.m.

**TO** ..... 08.30 - 9.30 a.m.

Fixed deposit per week based on the current rates:

200€ X .....weeks = €

+ booking fee..... = 25.00 €

**Total cost (including booking fee).... = \_\_\_\_\_ €**

**RESERVATIONS MUST BE MADE BY:**

**I declare having received the booking conditions, in being familiarized with them, to accept and follow them.**

Place

Date

“Read and approved” + SIGNATURE

- **PAYMENT BY BANKCARD:** VISA-EUROCARD-MATERCARD-MAESTRO

card n° - - - - -

EXP --/--

+ last 3 digits on the back of your card - - -

Authorization to use the card, **DATE:**

**SIGNATURE:**

- **TRANSFER:** **IBAN** FR76 1910 6006 0100 2756 8401 507

**CODE BIC** AGRIFRPP891 – CREDIT AGRICOLE



## GENERAL CONDITIONS FOR THE RESERVATION OF A CORSAIRE MOBILE HOME

2 Mobile homes > 5 years

Concerning the converted site of an equipped mobile home (electricity 10 Amps), it is forbidden to use electricity to charge vehicle.

Reservation is on a weekly basis (1 or more weeks), arrival between 5 and 7 p.m. departure between 8.30 and 09.30 a.m.

The **fixed deposit** for a mobile home reservation, as well as the booking fee, are payable upon reservation; the balance and security deposit are due upon arrival, before the distribution of keys. The booking fee (25€), due for an additional service, are not refundable. Booking fee offered if the whole stay (with City Taxes) is paid upon reservation. For any late arrival (after 7 pm) and/or without reservation, support fee (25€) will be charged.

The security deposit will be refunded at the end of the stay if no degradation has occurred to the equipment and if the mobile home is properly cleaned.

The reservation will not be effective until the deposit has been collected, which must be received **within 7 days** after reception of the reservation voucher.

**For all reservations made less than 15 days in advance, the totality of the payment is due by bankcard only, offer valid for 48 hours.**

### **CANCELLATION IN THE EVENT OF JUSTIFIED FORCE MAJEURE:**

More than 6 weeks before arrival, full reimbursement of the deposit for a mobile home, less processing fee (25€).

Less than 6 weeks before arrival, no reimbursement.

Ask for the FFCC's cancellation insurance.

The arrival time is guaranteed for 24 hours, except with particular terms.

Animals are **PROHIBITED** for hygienic reasons.

The mobile home is intended for 2 persons maximum.

### **IMPORTANT:**

**THE BALANCE DUE ON THE RESERVATION OF A MOBILE HOME MUST BE PAID UPON ARRIVAL**, as well as the **SECURITY DEPOSITS 280 €** (equipment and cleaning). They will be repaid the day you leave: 200 € if nothing is lost or damaged; and 80 € if the CORSAIRE is as clean as on your arrival, final cleaning done by yourself.

Any modification that may necessitate a change in charges must be signaled upon arrival. For an earlier departure or later arrival no reimbursement is possible, for any reason.

It is prohibited to recharge any electric vehicle in the campsite. Our campsite is not equipped with charging stations.

Clause conferring jurisdiction: any eventual litigation will be treated by the Tribunal of Grasse.

Dear Client,

These precisions are necessary to avoid any ambiguity. We thank you for your continued confidence and hope that you will enjoy your vacation with us.

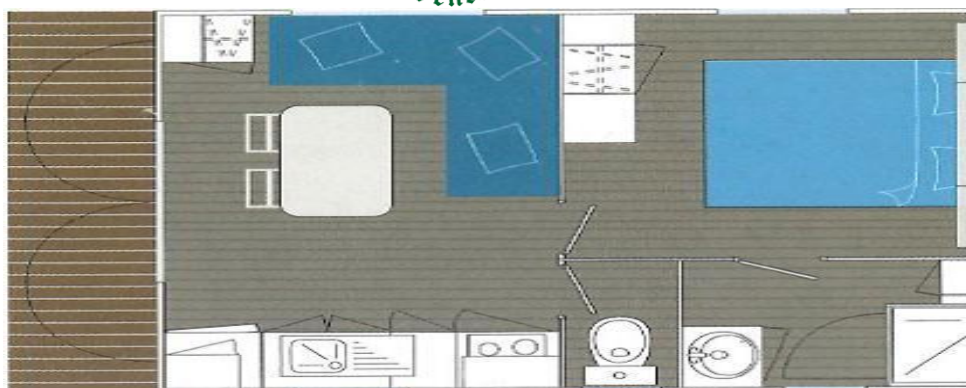

6m X 4 m outdoor, indoor 20 m<sup>2</sup> + terrace 8 m<sup>2</sup>

## MOBILE HOME CORSAIRE INVENTORY

Sites 181 & 210

6 PLATES  
 6 HALLOW PLATES  
 6 SMALL PLATES  
 4 COFFEE CUPS  
 4 STACKABLE MUGS  
 4 BOWLS  
 2 EGG CUPS  
 1 SALAD BOWL PYREX Ø 21 cm  
 1 SALAD BOWL Ø24 cm  
 1 ROUND HALLOW DISH Ø 28 cm  
 6 GLASSES FOR WATER  
 6 GLASSES FOR WINE  
 1 GLASS PITCHER  
 6 INOX FORKS  
 6 INOX BIG SPOONS  
 6 INOX SMALL SPOONS  
 6 KNIVES  
 1 USTENSIL BASKET 5 CASES  
 1 TIRE CAP AND BOTTLE-OPENER  
 1 POTATO PEELER + 1 TIN OPENER  
 1 PARING KNIFE  
 1 SALAD SET  
 1 WOODEN SPATULAS  
 1 NYLON LADLE +1 NYLON SKIMMER  
 1 NON STICK FRYING PAN Ø28 cm  
 1 INOX SAUCEPAN Ø 12 cm  
 1 INOX SAUCEPAN Ø 18 cm  
 1 INOX STEW POT + GLASS COVER  
 1 UNIVERSAL INOX COVER Ø20  
 1 RECTANGULAR TRAY IN MELAMINE  
 1 SQUARE TABLE MAT 20 cm  
 1 PLASTIC COLANDER Ø 26 cm  
 TOWELS AND LINEN NOT PROVIDED  
BED LINEN RENTAL on demand **30 €**  
TOWELS RENTAL on demand **16 €**  
DISPOSABLE SHEETS **12 €**  
FINAL CLEANING **80 €**

1 KETTLE  
 1 WHITE PLASTIC CUTTING BOARD  
 1 TRAY ICE CUBE  
 1 BROOM BRUSH  
 1 NYLON BROOM  
 1 BUCKET 10 L  
 1 SQUARE PLASTIC BOWL 30 X 30  
 1 SMALL PLASTIC BROOM AND DUST SHOVEL  
 1 WC BRUSH + WHITE HOLDER  
 6 PLASTIC HANGERS  
 1 PLASTIC DOORMAT  
 1 CLOTH DRYER + CLOTH PINS  
 1 CARBAGE CAN 15 L + LID  
 1 WHITE ELECTRIC COFFEE MACHINE BOSCH  
 1 MICRO WAVE OVEN 20 L  
 1 COVER BELL FOR MICRO WAVE  
 1 TELEVISION + 1 REMOTE CONTROL

PLEIN-AIR 2 PERSONS  
 2 ARMCHAIR SUNBATHING  
 1 OUTDOOR SQUARE TABLE  
 4 OUTDOOR CHAIRS

2 DECORATIVE CUSHIONS  
 2 WHITE PILLOWS 60 X 60  
 2 UNDER PILLOW CASES  
 2 PLASTIFIED UNDER SHEET 80 X 190  
 2 COTTON UNDER SHEETS 80 x 190  
 BLANKET FOR 2 PERSONS BED 160 X 190

Place ..... Date .....  
 Signature to be preceded by the mention READ AND APPROVED

Updated January 2025



# MOBIL HOME RENTAL CORSAIRE

2 available > 5 years

## PRICES 2025

Excluding tourist taxes \*

			Week	Night mini 3 <7 N	Extra Night > 7 N
<b>CORSAIRE</b> 20 m <sup>2</sup>  <b>MAXIMUM</b> 2 persons	<b>LOW SEASON*</b>	2 persons	<b>450 €</b>	<b>90 €</b>	<b>80 €</b>
	<b>SEASON 07.12-08.23.20245</b>	2 persons	<b>690 €</b>	<b>130 €</b>	<b>110 €</b>

\***TOURIST TAX:** 0.80 € /night/person over 18 years

\***LOW SEASON:** 03.25 - 07.11.2025 and 08.23 -10.15.2025

This set price includes the pitch + 1 car or 2 motorbikes + 2 people + water + electricity, no electricity for vehicle. Rental per week, arrival between 5 and 7 pm, departure between 8.30 and 9.30 am  
For one more car or trailer, you must pay the exact fees of the campsite.

**BOOKING OR SUPPORT FEES:** 25 €

FEES OFFERED IF TOTAL PAYMENT WITH TPOURIST TAXES ON BOOKING

200€ down payment for booking + 25 € booking fees, payment: Bankcard (Visa, MasterCard, Maestro) or transfer, and you must pay the balance the day of your arrival + Tourist Tax.

For any late arrival (after 7 pm) and/or without reservation, support fees (25 €) will be charged

No repayment, for an earlier departure or later arrival.

**DEPOSIT:** 280 €

200 € + 80 € for the cleaning = 280 € paid the day of your arrival. They will be repaid (200 €) the day you leave if nothing is lost or damaged, and 80 € if the Mobil home is as clean as on your arrival (final cleaningdone by yourself).

**PETS ARE FORBIDDEN**

**LINEN RENTAL:** 30 € on demand when booking

**TOWELS RENTAL:** 16 € on demand when booking

**DISPOSABLE SHEETS:** 12 €

**FINAL CLEANING:** 80 €

All the lodgers benefit from all the campsite facilities: free access to the swimming pool (respect its rules), Tennis Court (price at the office), playground, fitness area, laundry (tokens at the office)...

**DISCOUNT LOW SEASON:**

\* 2 weeks -10 %

\* 3 weeks -15 %

\* 4 weeks -20 %

**DISCOUNT SEASON**

\* 4 weeks -15 %

Updated January 2025

1330 chemin de la Sine 06140 VENCE - ☎ 04 93 58 09 36

info@camping-domainedelabergerie.com

Pour tout litige seul le tribunal de Grasse est compétent – RC GRASSE B 327015236